

Features

- ◆ 550 W output power
- ◆ 36-75Vdc Input
- ◆ 12Vdc+12Vsb output
- ◆ High efficiency up to 92%
- ◆ N+N Redundant
- ◆ Digital Power Supply
- ◆ Hot-pluggable
- ◆ Active current sharing
- ◆ PMBus® compliant
- ◆ 40mm*73.5mm*185mm(H*W*D)

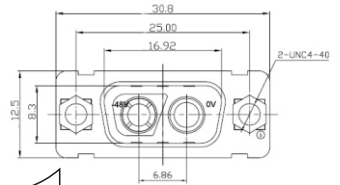

48V-DC-Input

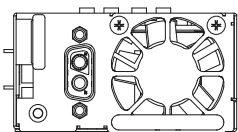
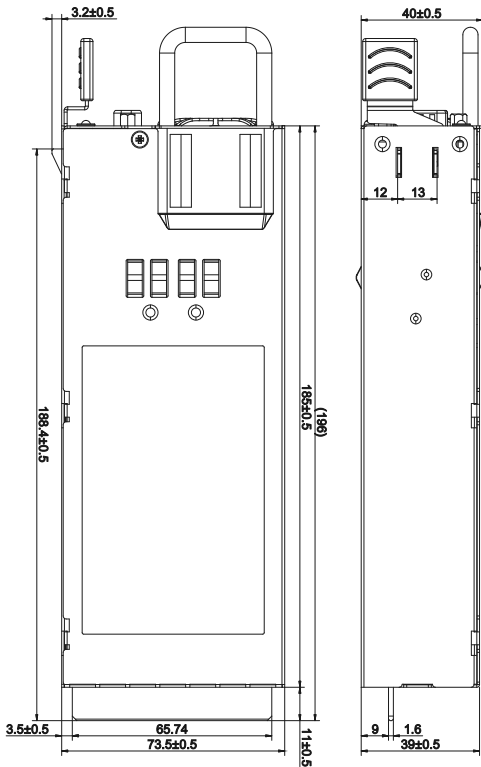
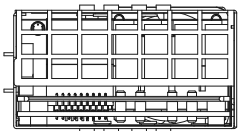

Input Characteristics		Units	Min.	Typ.	Max.	Notes
DC Input Voltage Range		Vdc	36	-	75	Converter guaranteed whole specification at input voltage range of 36~75V
DC Rated Input Voltage		Vdc	-	48	-	
Output Characteristics		Units	Min.	Typ.	Max.	Notes
Output Voltage set point	12V Main	Vdc	11.4	12	12.6	Vin=Vin(nom) lo=0 to lo(max)
	12Vsb	Vdc	11.4	12	12.6	
Output current	12V Main	A	-	-	45	Vin=V(min) to Vin(max)
	12Vsb	A	-	2	-	
Output Power		w	-	-	550	Vin=V(min) to Vin(max)
Line Regulation (12V, 12Vsb)		V	-	-	1	40~75Vin, lo=lo(max)
Load Regulation (12V, 12Vsb)		V	-	-	1	40~75Vin
Capacitive Load	12V Main	µF	-	-	25000	
	12Vsb	µF	-	-	3300	
Ripple and Noise (12V, 12Vsb)		mVp-p	-	-	200	Measured with 10µF Tantalum capacitor and 1µF ceramic capacitor at output
Start-up Time (12V Main)		mS	-	20	-	0~100% of max lo
Protection Characteristics		Units	Min.	Typ.	Max.	Notes
Input Under Voltage Protection	Turn-on input Voltage(12V)	Vdc	34	35	36	
	Turn-on input Voltage(12Vsb)	Vdc	33	34	35	
Input Overvoltage Protection		Vdc	76.5	77.5	80	
Output Over Voltage Protection		Vdc	13	-	15	
Current Limit Threshold (12V Main)		A	-	95	100	
Short Circuit Current (12V Main)		A	-	-	5	
Efficiency		%	91	92	-	Vin(nom), Ix(nom), Vx(nom), Ta=25°C
General		Units	Min.	Typ.	Max.	Notes
MTBF		H	100,000	-	-	100% of max continues load,
Safety		Compliant to IEC62368-1, UL62368-1, EN62368-1 and GB4943.1				
Environment		Units	Min.	Typ.	Max.	Notes
Operating Temperature		°C	0	-	70	Vin(nom), Ix(nom), Vx(nom), Ta=25°C
Storage Temperature		°C	-40	-	70	100% of max continues load, reference to Telcordia SR332
Relative Humidity		%(H)	0	-	95	Non-condensing
Operating Altitude		m	0	-	5000	

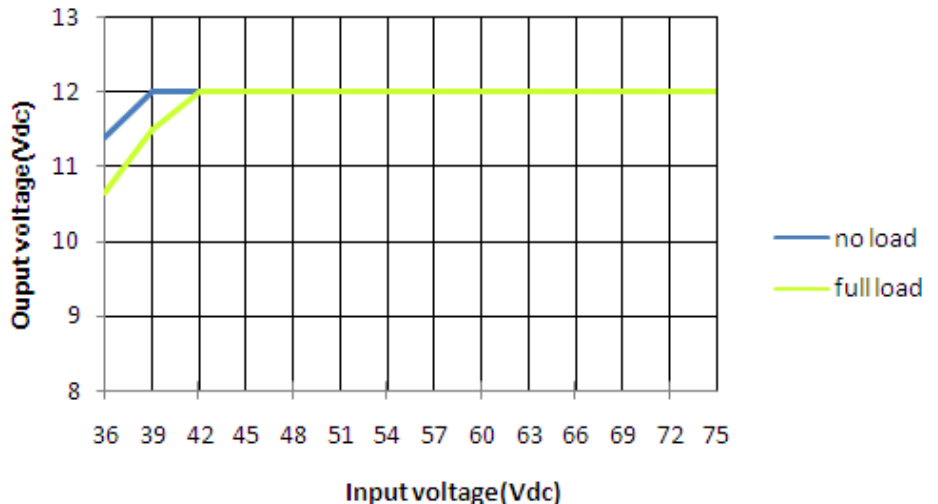

Output voltage vs. load current and input voltage at TP1 = +25°C.

Tel: +86(755)-86000600
 Fax: +86(755)-86001330
 E-mail: postmaster@suplethic.com

Shenzhen, Guangdong, CHINA

Disclaimer: This content is subject to change, please refer to specification for more detail. SUPLET reserve the right to change the content without prior notice